

THREAD GROUND

- MATERIAL: SNCM 21
- HARDNESS: HRC 54 $\pm$ 2 $^{\circ}$
- SHANK BT-30(P 30T)
- SHANK BT-40(P 40T)
- SHANK BT-50(P 50T)

Unit:mm

ORDER NO.	TAPER NO.	a $^{\circ}$	L	L1	L2	D	d1	d2	d3	M	NOTE	CODE NO.
BT-510	BT30X90 $^{\circ}$	90	43	23	18	16.5	11	7	12.5	M12	P30T-3(90 $^{\circ}$ )	3215-007
BT-501	BT30X45 $^{\circ}$	45	43	23	18	16.5	11	7	12.5	M12	P30T-1(45 $^{\circ}$ )	3215-008
BT-502	BT30X60 $^{\circ}$	60	43	23	18	16.5	11	7	12.5	M12	P30T-2(60 $^{\circ}$ )	3215-009
BT-511	BT40X90 $^{\circ}$	90	60	35	28	23	15	10	17	M16	P40T-3(90 $^{\circ}$ )	3215-010
BT-503	BT40X45 $^{\circ}$	45	60	35	28	23	15	10	17	M16	P40T-1(45 $^{\circ}$ )	3215-011
BT-504	BT40X60 $^{\circ}$	60	60	35	28	23	15	10	17	M16	P40T-2(60 $^{\circ}$ )	3215-012
BT-512	BT50X90 $^{\circ}$	90	85	45	35	38	23	17	25	M24	P50T-3(90 $^{\circ}$ )	3215-013
BT-505	BT50X45 $^{\circ}$	45	85	45	35	38	23	17	25	M24	P50T-1(45 $^{\circ}$ )	3215-014
BT-506	BT50X60 $^{\circ}$	60	85	45	35	38	23	17	25	M24	P50T-2(60 $^{\circ}$ )	3215-015

# Pull Studs

MAS 403  
BT-40,50

JIS B6339-1986

• With through hole for internal coolant

FOR MAS 403

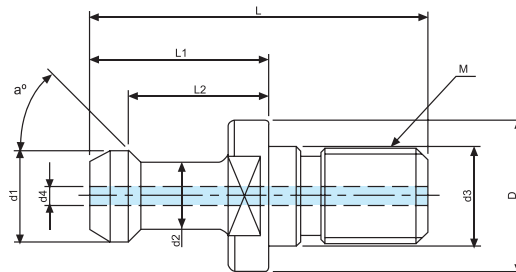

Unit:mm

ORDER NO.	TAPER NO.	a $^{\circ}$	L	L1	L2	D	d1	d2	d3	d4	M	CODE NO.
BT-516	BT40X45 $^{\circ}$ W	45	60	35	28	23	15	10	17	4	M16	3215-060
BT-517	BT40X60 $^{\circ}$ W	60	60	35	28	23	15	10	17	4	M16	3215-061
BT-518	BT40X90 $^{\circ}$ W	90	60	35	28	23	15	10	17	4	M16	3215-062
BT-519	BT50X45 $^{\circ}$ W	45	85	45	35	38	23	17	25	7	M24	3215-063
BT-520	BT50X60 $^{\circ}$ W	60	85	45	35	38	23	17	25	7	M24	3215-064
BT-521	BT50X90 $^{\circ}$ W	90	85	45	35	38	23	17	25	7	M24	3215-065